

Create pdf

Lampholders and starter holders

26.926.-311

G5 End fixing lampholders



pkg. part no.
500 26.926.-311.50

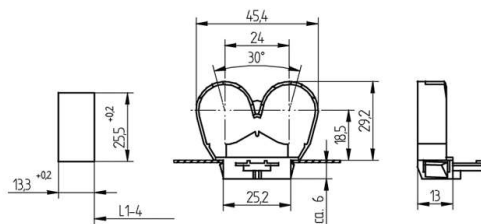

Twin end cap for lampholders 26.641.2006.50
Snap in foot 25.5 x 13.3 mm
Material: PC

L1-4: Recommended dimension - The distance between the cut-outs and the tolerance should be governed by the dimensions of the respective lamps and luminaires.

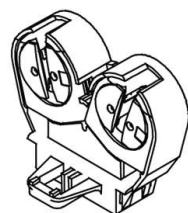

Example of application
Top Test holes are not accessible when mounted in twin end cap.

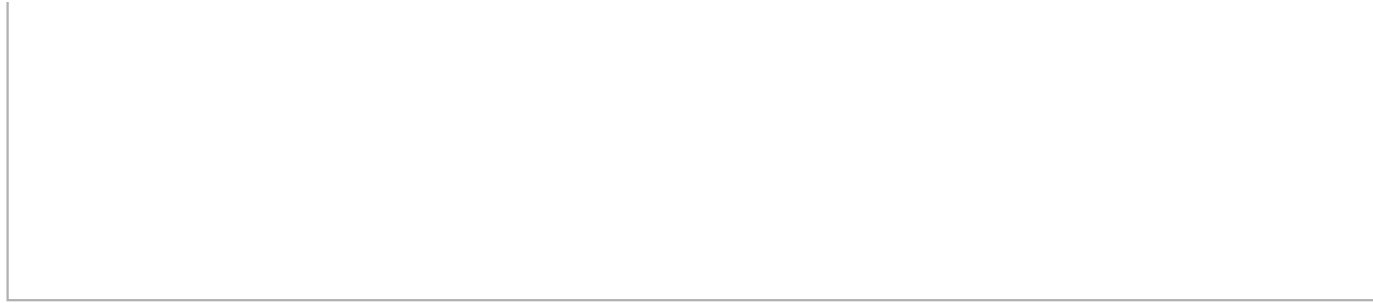

Document generated on: Th, 9. February 2017 - 12:01